

AT858D HOT AIR REWORK STATION MANUAL

Introduction

- Closed-loop sensors
- Zero-crossing triggering temperature control of microcomputer
- LED display
- high power
- rapid rise of temperature
- Stable temperature
- The amount of air flow can be modulated; large and soft air flow; it is convenient to modulate temperature; it is suitable for many purposes
- There is a conductive switch on the handle; only if you hold the handle, the system can enter the working mode rapidly; while the handle is put on the shelf, it will enter the waiting state; easy to operate.
- There is no automatic cooling function, which can extend the lifespan of the heating element and protect the hot air rework station.
- Plastic shell; cabinet; good-looking; it occupies little space.

Technical Parameters

Model	AT858D+
voltage	AC220V/50Hz
Power consumption	700W
Type of air pump	Gentle wind of brushless fan
Gas flow	120L/min(MAX)
Temperature range	100-450°C
Length of handle(including the wire)	1.2CM
Size	151(L)*100(W)*153(H)mm
Weight	About 1.5KG
noise	<40dB
Display	LED(DIGITAL)(RESOLUTION,1)

Warning

Before using the hot air rework station, you must abide by the following measures in order not to get an electric shock, result in damages to people or result in fire, etc.

- In order to secure the safety of people, you must use the parts or accessories that the factory of origin certificates or recommends; or it will lead to serious aftermaths.
- This rework station must be repaired by qualified technicians or the appointed person by us.
- Be careful, for it is operated at a high temperature. Don't use it near flammable and explosive gas and objects, for the tip and the air from it are steaming-hot, which can burn people. Don't touch the heating element or spray the hot air against people.
- When the hot air rework station starts to work, don't leave from your post.
- Keep away from children.
- When it starts to work, don't install the nozzle until the heating pipe and nozzle are cooled.
- Please keep the draughts of input and output expedite; there should be no block.
- After using it, remember to cool the machine. You should put the handle on the shelf. When the machine is in the waiting state, you can make the power off.
- If you don't use it for a long time, you should put the connector plug off.

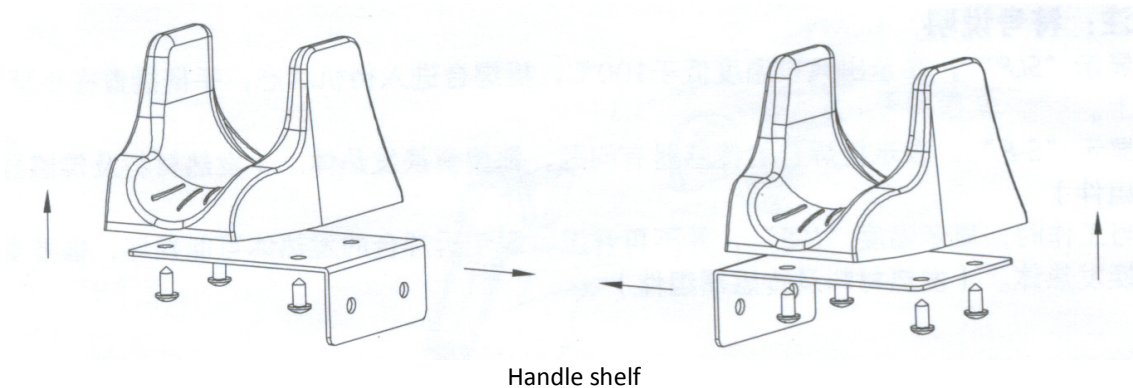

Replaceable Parts

NO.	Name of parts	Instruction
1	Components of the handle 220V	
	Components of the handle 110V	
2	Handle shell	
3	858 PCB(component)	LED-based Instruction
4	AT858D+ PCB(component)	LED Microcomputer Digital Display
5	pump	
6	858 heating core 220V	
7	858 heating core 110V	
8	Handle shelf	
9	858 nozzle	One set

Usage

- Soldering and de-soldering the most of the SMD component, such as SOIC, CHIP, QFP, PLCC, BAG and so on.
- De-solder different shielding boxes or shielding covers conveniently. Make heat shrinkage for the heat-shrink tube and the PVC tube.
- Warm-up the mini-type metal and the mechanism, relax firm components.
- It can be used for the lapped soldering for the PVC paint and the composition cloth, and the soldering of the bitumen for the roof. And use the high temperature to do disinfection works for animal cages
- Make the PVC, PS, high temperature plastic and the wood formed.
- Make the thaw for the ice, conduit pipe and mechanism.
- Make the paint, the strainer and the glue water heating dry.
- For all the heating without fire.

Temperature Setting

Air Rework Station of LED-based Instruction Rotate temperature control knob to the desired location of the temperature scale line.

Hot Air Rework Station of LED Microcomputer Digital Display: When connecting the power, press the connected keys; then the setted temperature will appear on the temperature display window. Press the key that is upward; then the setted temperature will rise by 1, which will appear on the display window. Press the key that is downward; then the setted temperature will fall by 1. If the two keys are pressed successively, the temperature will rise or fall rapidly. If you release the pressed keys, the setted temperature will appear for two seconds on the display window and then the actual temperature will appear.

Symbol Description

- Display “SLP ”, means the outlet temperature is lower than 100 and the rework station enters the waiting mode. The handle should be put on the handle shelf.
- Display “S-E ”, means there is something wrong with the sensor of the rework station. The heating elements should be changed.(heating elements and components of the sensor)
- When operating, the display temperature “H-E ”, means that the temperature will not rise and the heating elements of the rework station may be damaged; the heating elements should be changed.(heating elements and components of the sensor)

Operation Instructions

- There may be very high temperature in the outlet or near it. Be careful in order not to get hurt.
- The heating handle must be put on the handle shelf. Don't put it on the table or other places.
- Keep the blowing way unblocked.
- After using, make sure the unit cool down, put it in a safe place. After turn the power off, the unit will automatically blow cool air for a short time. Don't disconnect the plug during this cooling process, it will power off automatically about one minute later.
- When operating, the distance between the outlet and the object should be at least 2mm on the basis of the outlet.
- According to the requirements of work, choose the suitable nozzle, for different nozzles are a little different in temperature.

Replacement Of The Heating Element

- Replace the heating element after they are cool.
- Remove screws of the handle.
- Remove the fan, and disconnect the connecting wire of the heating element, pay attention to the position for the connecting wire.
- Take out the heating element and the mica paper from the steel tube, and do not break the mica paper.
- Use the mica paper to pack up the heating element, insert it in the steel tube, and the installation of the heating element should be on the designated position, and do not let it touch the ground wire.
- Connect the connecting wire of the heating element according to the original position.
- Install the handle and screw down the screws.

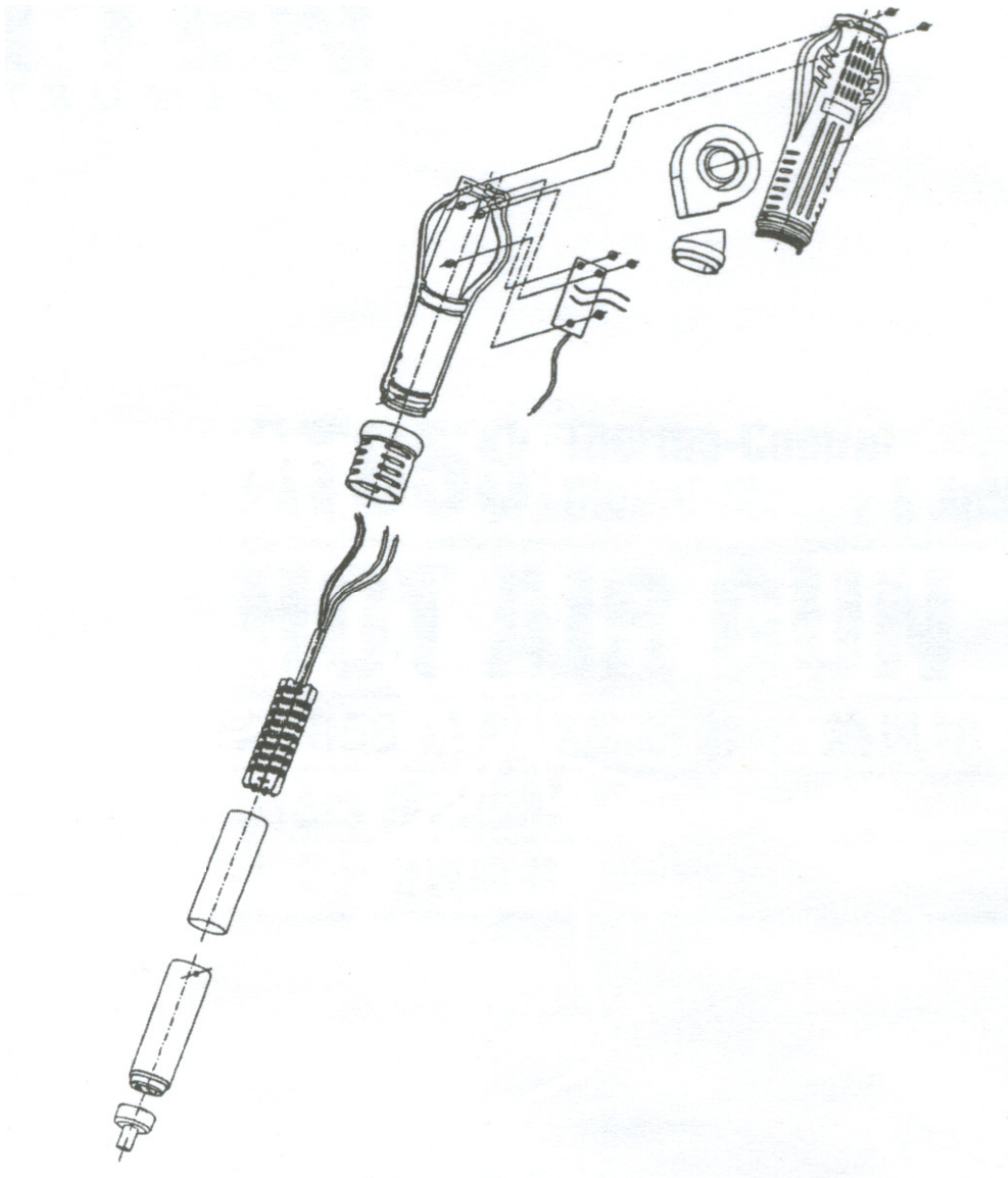

handle assembly